

PROCURAL formerly Ponzio Polska

PF152EI

EI30, EI60

CURTAIN WALL SYSTEMS

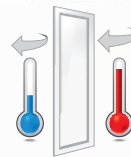
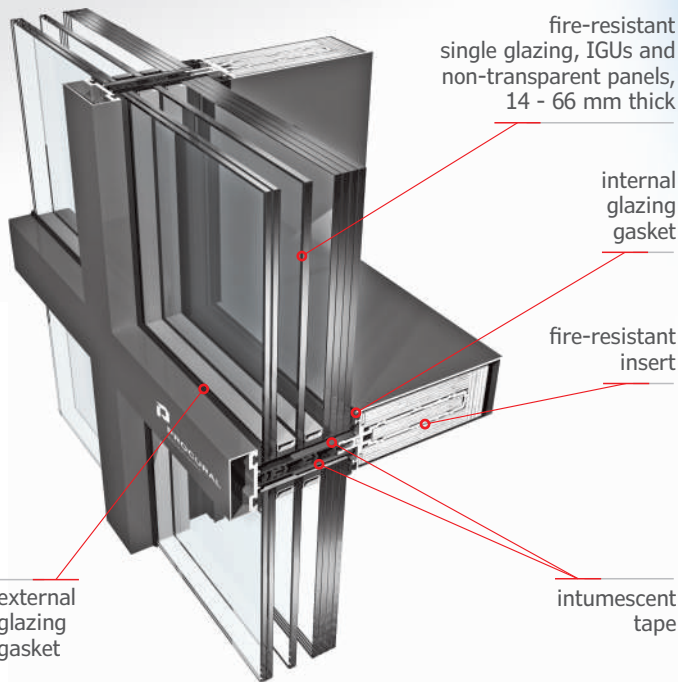

$$U_{cw} = 0.78 \text{ W}/(\text{m}^2\text{K})$$

*reference construction dimensions: L 1200 x H 2500 mm
 $U_g = 0.5 \text{ W}/(\text{m}^2\text{K})$, triple glazing

A fire-resistant variant of the PF152 curtain wall system, classified EI30 and EI60.

- EI30 or EI60 classified curtain wall system designed using fire-resistant inserts, internal reinforcing profiles and dedicated mullion-transom connections
- fillings mounted using pressure slats or semi-structurally, using discrete mounting points and structural sealing (ESG variant)
- various cover plates available
- fire-resistant curtain walls with the possibility of making spandrels
- angular connections up to +/- 7.5° per side (filling rotated about the mullion) and multiplanar curtain walls using non-transparent corner solutions (two mullions + flashing per each angular connection) possible
- inclined curtain walls up to +/-10° possible
- PE78EI fire-resistant windows and doors may be used as filling

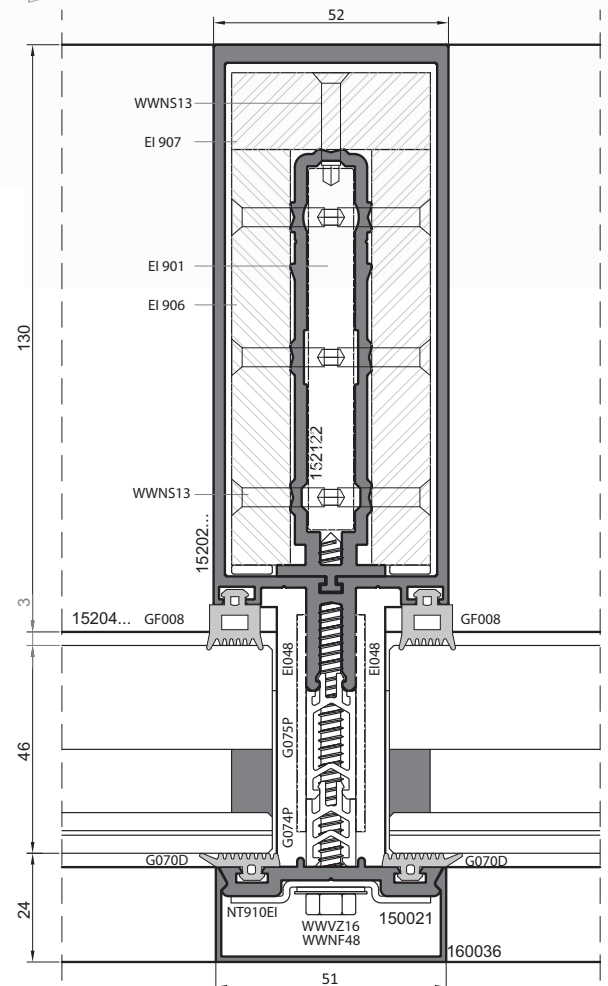

TECHNICAL PARAMETERS

Filling thickness	14 - 66 mm
Mullion depth	85 - 196 mm
Transom depth	91 - 201 mm
Mullion and transom width	52 mm
Thermal insulation	U_o from 1.7 W/(m ² K) U_{cw}/U_w from 0.78 W/(m ² K)
Air permeability	class AE 2100
Watertightness	class RE 2100
Classification	(standard) class RE 2100 (ESG) class RE 2700

Certification

1. Type testing classification for the standard variant: 03-01561/19/R126NZE - EN
2. Type testing classification for the ESG variant: - EN
3. Walls and roof coverings fire spreading assessment: 01561/16/R83NZE
4. Full and part configuration curtain walling fire resistance classification: 01561/23/R183NZE